



OnTime

Powered by ClockedIn



Beacon Terminal

Beacon Terminal – Battery Replacement & Installation

Guidelines

Battery Replacement

When the Beacon Battery percentage is lower than 5%, the red LED light blinks twice in 10 second intervals to indicate that the battery is low. Please follow the steps below in order to replace the CR2477 battery



Figure 1: Top view of M2 Beacon

Figure 2: Back view of M2 Beacon

Disassemble Flow Diagram



1. Unscrew fittings/remove from sticky pad.
2. Disassemble the bottom case and remove the current battery.



3. Install the new battery and close the case.



4. Attach the Beacon using the fitting/sticky pad and install back to the original location.

Powering On/Off

The beacon may only require restarting after the battery has been replaced, it should not be powered off for any other reason.

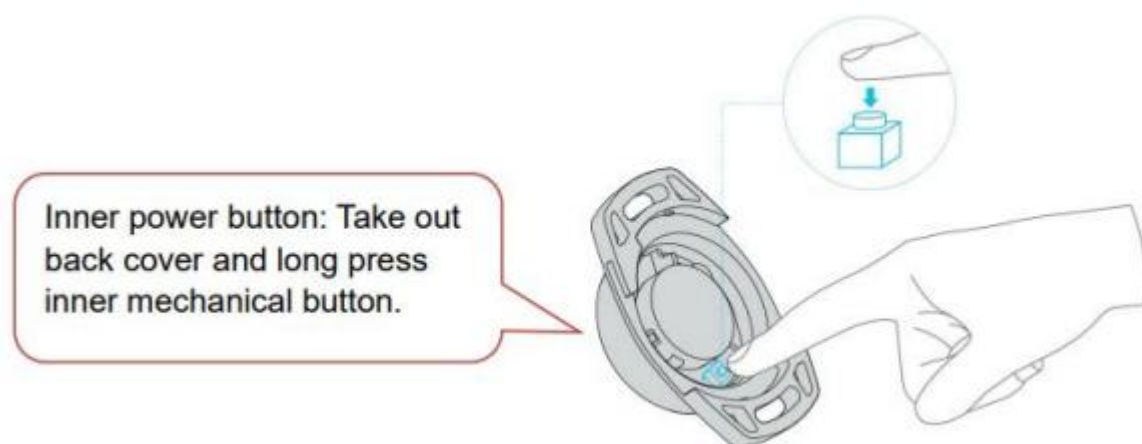

Installation Guidelines

Minimising the space between the Beacon nodes will increase the system's accuracy.

- If there is a 10-metre spacing between the Beacon nodes, it can offer an average accuracy of 2 metres.
- If there is a 15-metre spacing between the Beacon nodes, it can offer an average accuracy of 4 metres.

Mirrors and metal objects effect the accuracy of the Beacon due to their reflection on the Bluetooth signal propagation.

Positioning the Beacon nodes closer to each other is not going to increase the accuracy of the Beacons because they have the same signal strengths.

The physical location of Beacons has a noticeable impact of accuracy. The manufacturers recommendation is to install them in the following locations:

- An object that is extremely close to the ceiling
- On the upper area of a wall
- Inside a false ceiling
- On the ceiling
- On an item that is close to the ground
- On the lower part of a wall/column
- On the ground

Two Methods of Installation

